



S & P Coil Products Limited

# BELGRAVIA Chassis - Technical Data Sheet

5 styles of Belgravia Chassis units are available, each comes in 3 sizes. The 5 styles and technical data for each size is shown below.

All styles can have left-hand or right-hand coil connections with top or bottom pipe entry.

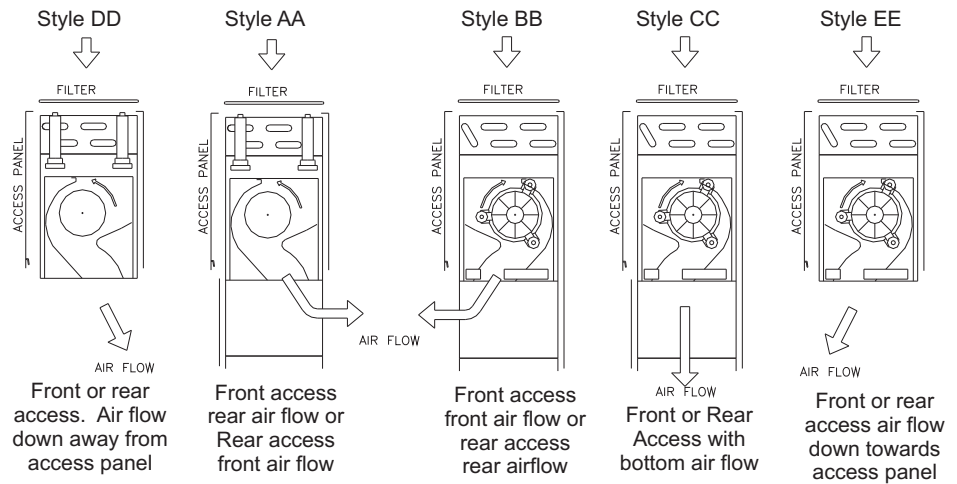

DIMENSIONS			
MODEL	Chassis Size 1 (ZA 1)	Chassis Size 2 (ZA 2)	Chassis Size 3 (ZA 3)
Length (mm)	632	832	1132
Height (mm)	500		
Depth (mm)	195		

TECHNICAL SPECIFICATION									
MODEL	Chassis Size 1 (ZA 1)			Chassis Size 2 (ZA 2)			Chassis Size 3 (ZA 3)		
Fan Speed	Boost	Medium	Low	Boost	Medium	Low	Boost	Medium	Low
Air Flowrate (l/s)	140	115	100	220	180	155	280	240	200
Output 80/70/15°C (kW)	5.9	5.2	4.7	9.1	8.0	7.3	12.4	11.3	10.0
Air Exit Temp 80/70/15°C (°C)	50.3	52.6	54.1	49.1	52.0	54.2	52.1	54.2	56.6
Pressure Drop 80/70/15°C (kPa)	4.0	3.0	3.0	9.0	7.0	6.0	18.0	15.0	12.0
Water Flow Rate 80/70/15°C (l/s)	0.14	0.12	0.11	0.22	0.19	0.17	0.30	0.27	0.24

**NOTES:**

- This data is based on the standard 2 row coil (3 row is available upon request)
- Coil supplied with 3/4 BSP connections on flow and return
- Motor/fan is a Ziehl Tangential unit with multitap transformer speed control
- All units are reverse airflow, there is no standard airflow configuration currently available
- Front, rear and bottom (in-line) outlet positions are available but inlet direction is always through the top
- All standard remote options are available
- Filter and LTC are supplied as standard
- Only available for LPHW
- Standard mounting is from jacking bolts in the plenum base or using a wall mounted fixing bracket
- The above diagrams show style DD and AA from left hand of the unit, style BB, CC and EE are shown from the right
- Left-hand bottom pipe entry connections are shown on all diagrams